

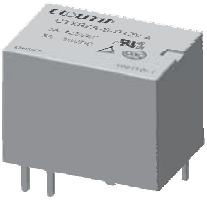

RELAY

超小型信号继电器/Miniature Signal Relay

CTXR2A系列 CTXR2A SERIES 	<ul style="list-style-type: none"> ● 特性 Features <ul style="list-style-type: none"> ● 超小型信号继电器外形尺寸 : (15.6x10.6x11.8mm) Miniature Signal Relay OUT Dimension: (15.6x10.6x11.8mm) ● 触点与线圈间浪涌电压高达 2500V Contact between coil and surge voltage up to 2500V ● 高灵敏度继电器 High sensitivity Relay ● 触点形式: 一组常开 Contact form: 1A
	<ul style="list-style-type: none"> ● 安规认证 Safety Approval 

触点参数/CONTACT DATA

触点形式 Contact Form	A-1 form A
接触电阻 Contact Resistance	50mΩ Max (6VDC 0.1A)
触点材料 Contact Material	银合金 Ag Alloy
触点负载 (阻性) Contact Rating (Resistive)	1A 125VAC/30VDC 3A 125VAC/30VDC
最大切换电压 Max.Switching Voltage	125VAC/30VDC
最大切换电流 Max.Switching Current	3A
最大切换功率 Max.Switching Power	375VA
机械寿命 Mechanical	1 10 ⁷ 次 1 10 ⁷ times
电气寿命 Electrical Life	1 10 ⁵ 次 (1A 125VAC/30VDC负载条件下) 5 10 ⁵ 次 (3A 125VAC/30VDC负载条件下) 1 10 ⁵ times (1A125VAC/30VDC Load conditions) 5 10 ⁵ times (3A125VAC/30VDC Load conditions)

性能参数/GENERAL DATA

绝缘电阻 Insulation Resistance	Min.100MΩ.500VDC	
介质耐压 Dielectric Strength	断开触点间 Between Open contacts	750VAC, 1min
	线圈与触点间 Between Coil and contacts	1500VAC, 1min
动作时间 (额定电压下) Operate time (Under rated voltage)		≤5ms
释放时间 (额定电压下) Release time (Under rated voltage)		≤5ms
冲击 Shock	强度 Endurance	980m/S ²
	稳定性 Misoperation	98m/S ²
振动 Vibration	强度 Endurance	10~55HZ, 1.5mm双振幅 10~55HZ, 1.5mm double amplitude
	稳定性 Misoperation	10~55HZ, 1.5mm双振幅 10~55HZ, 1.5mm double amplitude
湿度 Humidity	35%~95%RH, +40°C	
温度范围 Temperature range	-30°C~+70°C	
重量 Weight	约4.0g about 4.0g	

线圈参数/COIL DATA

额定线圈功率 (W) Rated Coil Power(W)	0.2W, 0.36W
-----------------------------------	-------------

安规认证/SAFETY APPROVAL

认证类型 / 认证号 Certified/File No.	触点形式 Contact Form	额定线圈功率 (W) Rated Coil Power(W)	额定线圈电压 (VDC) Rated Coil Voltage(VDC)	认证负载 Safety Approval Rating	备注 Remark
UL	A	0.2/0.36	3-24	3A 125VAC/30VDC	环境温度: 70°C Ambient Temperature:70°C
				1A 125VAC/30VDC	
TUV	A	0.2/0.36	3-24	3A 125VAC/30VDC	环境温度: 70°C Ambient Temperature:70°C
CQC	A	0.2/0.36	3-24	3A 125VAC/30VDC	环境温度: 70°C Ambient Temperature:70°C

线圈规格/COIL DATA

额定电压 Rated Voltage (VDC)	线圈电阻 Coil Resistance (Ω 10%)	吸合电压 Operate Voltage ≤ (VDC)	释放电压 Release Voltage ≥ (VDC)	最大电压 * Maximum voltage (VDC)
3	25	2.1	0.3	3.6
5	70	3.5	0.5	6.0
6	100	4.2	0.6	7.2
9	225	6.3	0.9	10.8
12	400	8.4	1.2	14.4
24	1600	16.8	2.4	28.8
3	45	2.25	0.3	3.6
5	125	3.75	0.5	6.0
6	180	4.5	0.6	7.2
9	405	6.75	0.9	10.8
12	720	9	1.2	14.4
24	2880	19	2.4	28.8

命名规则/OPDERING INFORMATION

CTXR2A -H -S -D12V -A (xxx)

客户特性号 :
Customer characteristic No:

触点转换形式: A- 一组转换
Contact Forms : A- 1 form A

额定线圈电压 (VDC) : 03, 05, 06, 09, 12, 24
Rated Coil Voltage (VDC) : 03, 05, 06, 09, 12, 24

封装形式: S-塑封型 SH-防焊剂型
Packing Forms: S-Plastic Sealed Type SH-Flux Model

额定线圈功率: H-高灵敏度0.2W 无 (H) 标准型0.36W
Rated Coil Power: H-High sensitivity(0.2W) Blank-Standard(0.36W)

型号: CTXR2A
Model: CTXR2A

外形图、接线图、安装孔尺寸(单位:mm) / OUTLINE DIMENSIONS、WIRING DIAGRAM、PCB LAYOUT(UNIT:mm)

外形图/Outline Dimensions

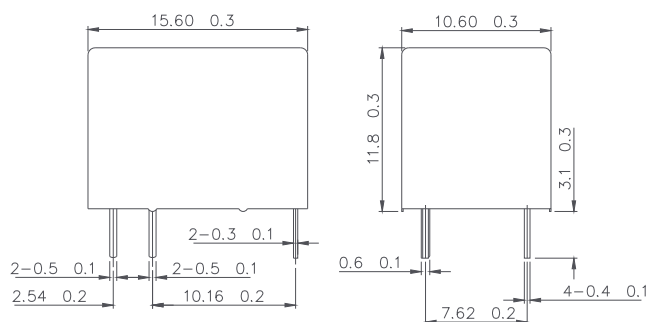

安装孔尺寸/PCB Layout
(底视图) / (Bottom View)

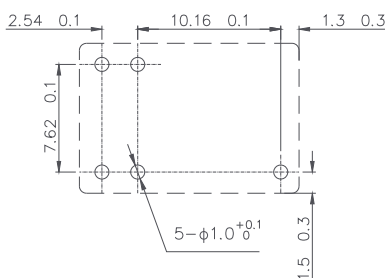

接线图/Wiring Diagram
(底视图) / (Bottom View)

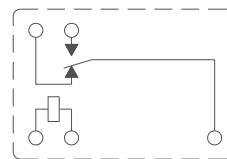

特性曲线图/CHARACTERISTIC CHART DATA

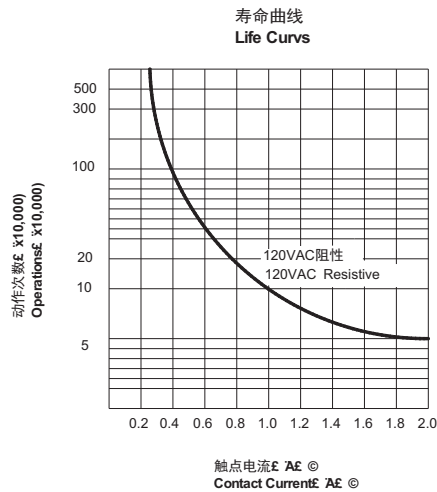
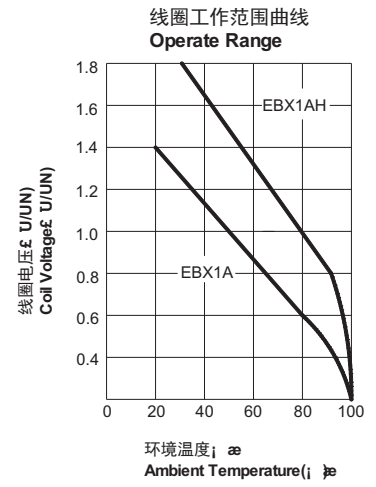
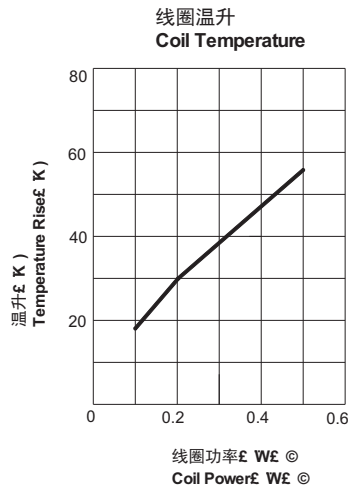
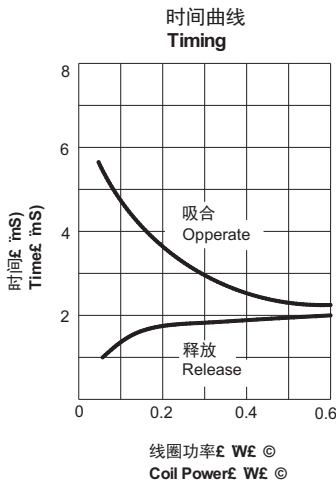

声明:

本产品规格书仅供客户使用时参考,若有更改,恕不另行通知。
 对本公司而言,不可能评定继电器在每一个具体领域的所有性能参数要求,因而客户应根据具体的使用条件选择与之相配的产品,若有疑问,请与云尖联系以便获取更多的技术支持,但选型责任仅由客户负责。
 Disclaimer: The specification is for reference only. Specifications subject to change without notice. We could not evaluate all the performance and all the parameters for every possible application. Thus the user should be in a right position to choose the suitable product for their own application. If there is any query, please contact "Cloutip" for the technical service. However, it is the use's responsibility to determine which product should be used only.